

XEROX.

# Quick Use Guide



Phaser® 6125



color laser printer

Printer Tour

Supported Papers

Basic Printing

Troubleshooting



More Information

[www.xerox.com/office/6125support](http://www.xerox.com/office/6125support)

- [Printer drivers and utilities](#)
- [User manuals and instructions](#)
- [Online Support Assistant](#)
- [Safety specifications](#) (in *User Guide*)

[www.xerox.com/msds](http://www.xerox.com/msds) (U.S./Canada)

[www.xerox.com/environment\\_europe](http://www.xerox.com/environment_europe)

Material Safety Data Sheets

[www.xerox.com/office/  
businessresourcecenter](http://www.xerox.com/office/businessresourcecenter)

Templates, tips, and tutorials



# Printer Tour

● Manual Feed Slot

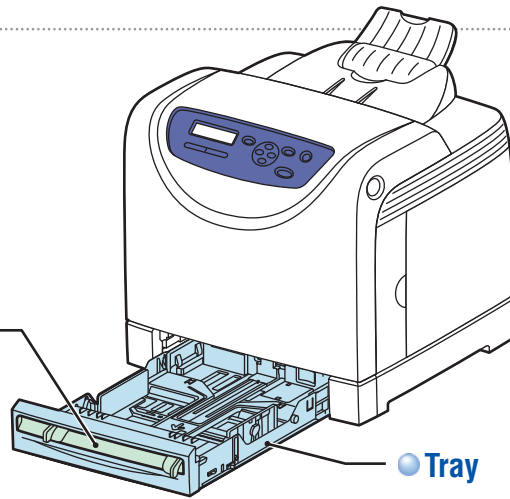

● Tray

● Toner Cartridges

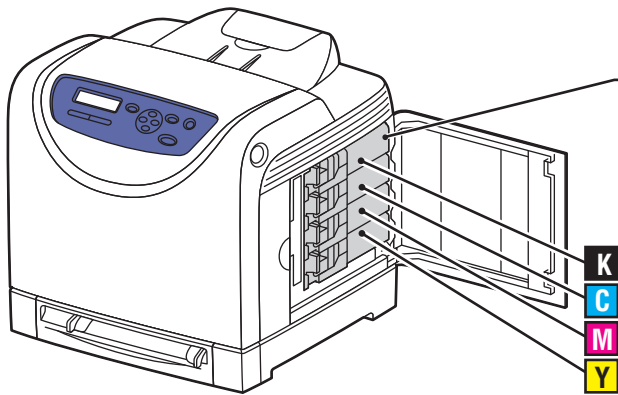

● Fuser

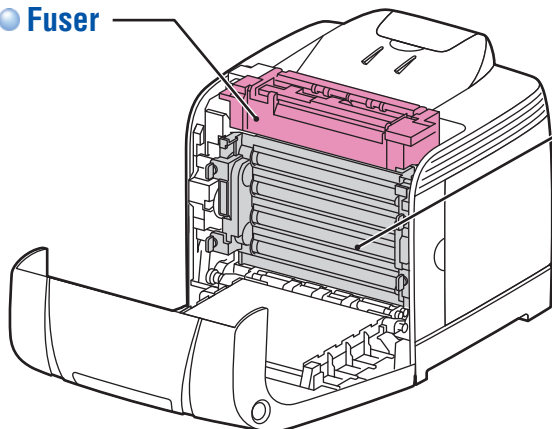

● Imaging Unit

● Activate menus on/off

● Move within a menu

● OK ✓

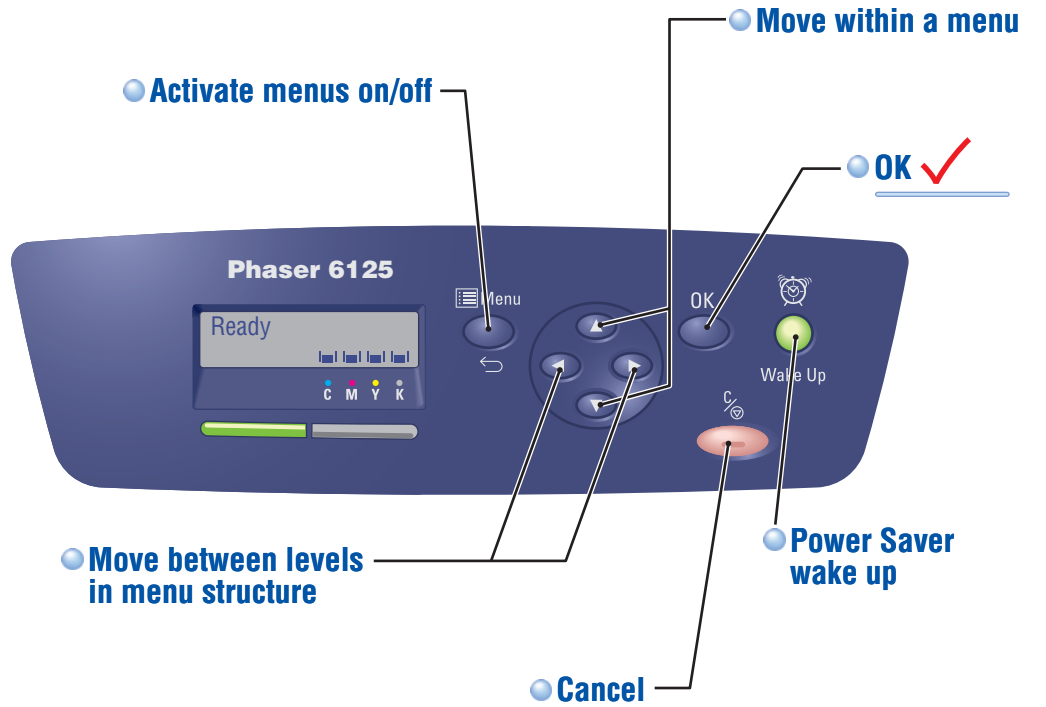

● Move between levels in menu structure

● Cancel

● Power Saver wake up

For ordering supplies, contact your local reseller, or visit the **Xerox Supplies** website.

[www.xerox.com/office/6125supplies](http://www.xerox.com/office/6125supplies)

[www.xerox.com/office/6125support](http://www.xerox.com/office/6125support)

# Supported Papers

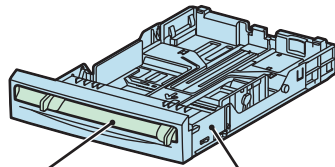
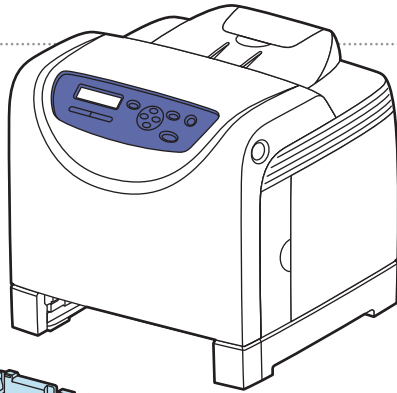

## Manual Feed Slot

**65 – 220 g/m<sup>2</sup>**  
(17 lb. Bond – 80 lb. Cover)

Letter	8.5 x 11.0 in.
Legal	8.5 x 14.0 in.
Executive	7.25 x 10.5 in.
Folio	8.5 x 13.0 in.
#10 Commercial	4.1 x 9.5 in.
Monarch	3.8 x 7.5 in.
A4	210 x 297 mm
A5	148 x 210 mm
DL	110 x 220 mm
C5	162 x 229 mm
Letter	8.5 x 11.0 in.
A4	210 x 297 mm

**Custom** ..... (SE) x (LE)  
SE: 76.2 – 216 mm (3.0 – 8.5 in.)  
LE: 127 – 355.6 mm (5.0 – 14.0 in.)  
B5 JIS ..... 182 x 257 mm

## Tray

**65 – 220 g/m<sup>2</sup>**  
(17 lb. Bond – 80 lb. Cover)

Letter	8.5 x 11.0 in.
Legal	8.5 x 14.0 in.
Executive	7.25 x 10.5 in.
Folio	8.5 x 13.0 in.
#10 Commercial	4.1 x 9.5 in.
Monarch	3.8 x 7.5 in.
A4	210 x 297 mm
A5	148 x 210 mm
DL	110 x 220 mm
C5	162 x 229 mm
Letter	8.5 x 11.0 in.
A4	210 x 297 mm

**Custom** ..... (SE) x (LE)  
SE: 76.2 – 216 mm (3.0 – 8.5 in.)  
LE: 127 – 355.6 mm (5.0 – 14.0 in.)  
B5 JIS ..... 182 x 257 mm

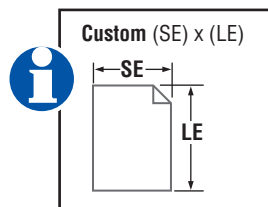

● **When loading paper: Select the correct type and size on the control panel.**

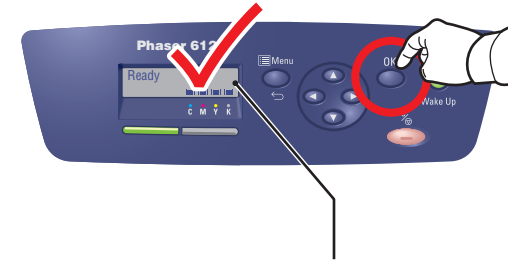

<b>65-120 g/m<sup>2</sup></b> (17-32 lb. Bond)	<b>Plain Paper</b>
<b>100-163 g/m<sup>2</sup></b> (28 lb. Bond – 60 lb. Cover)	<b>Thin Card Stock</b>
<b>160-220 g/m<sup>2</sup></b> (60-80 lb. Cover)	<b>Thick Card Stock</b>
<b>100-160 g/m<sup>2</sup></b> (28 lb. Bond – 60 lb. Cover)	<b>Glossy Paper</b>
<b>160-200 g/m<sup>2</sup></b> (60-80 lb. Cover)	<b>Thick Glossy Paper</b>

● **When Printing: Select properties. Use Xerox printer driver.**

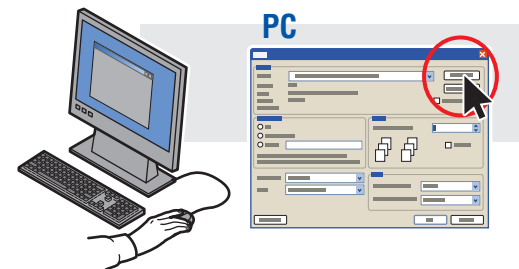

# Basic Printing

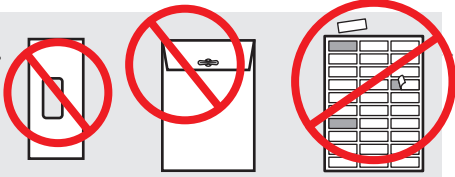

Tray  
Faceup

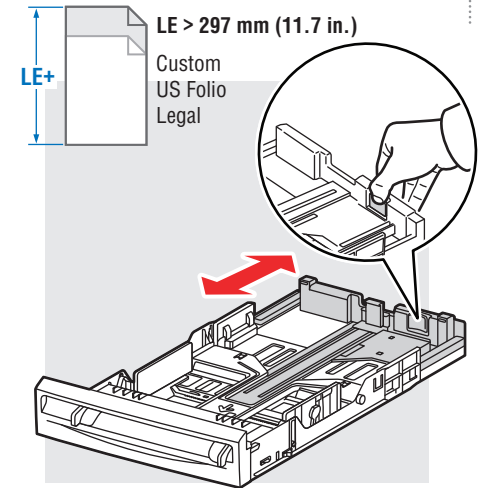
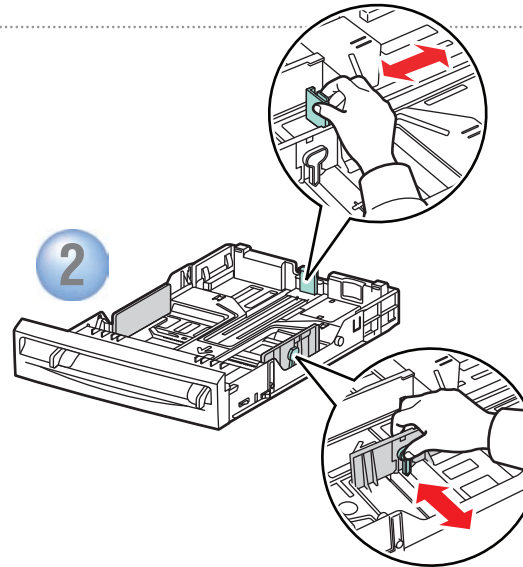
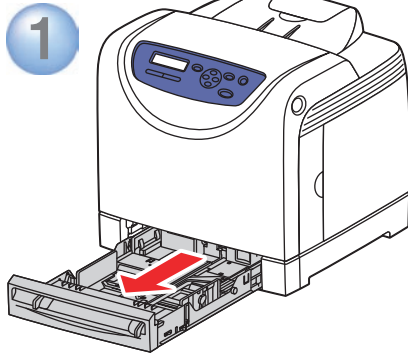
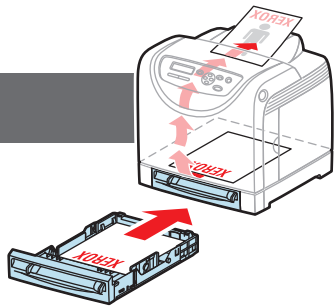

3

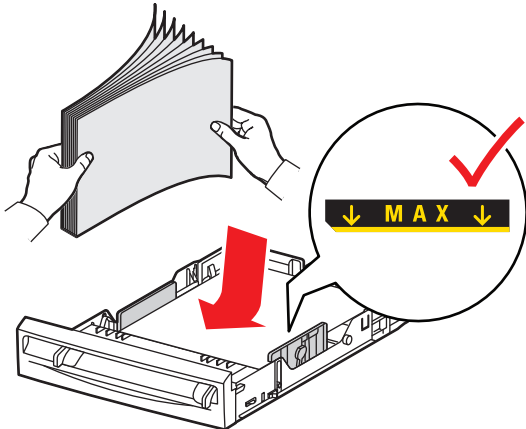

4

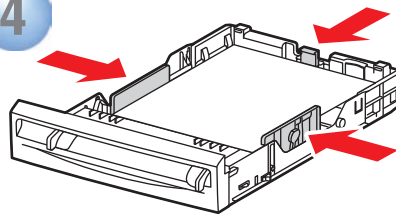

5

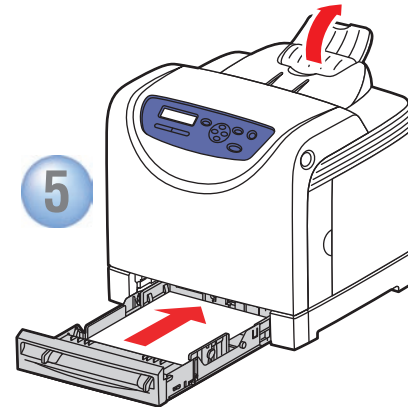

• See **Printing Basics** in the *User Guide* for more information.

Manual Feed Slot  
Facedown

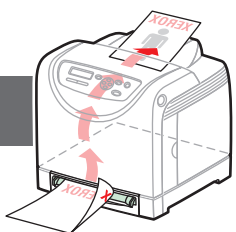

1

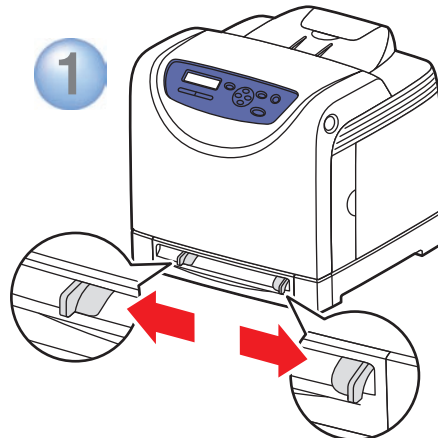

2

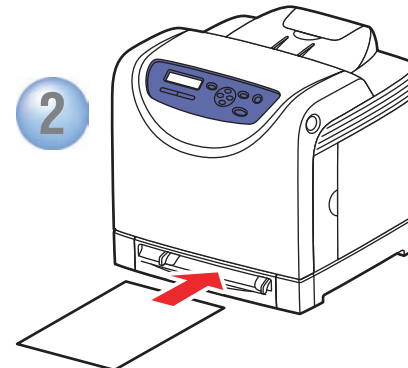

# Troubleshooting



## ● Paper Jams

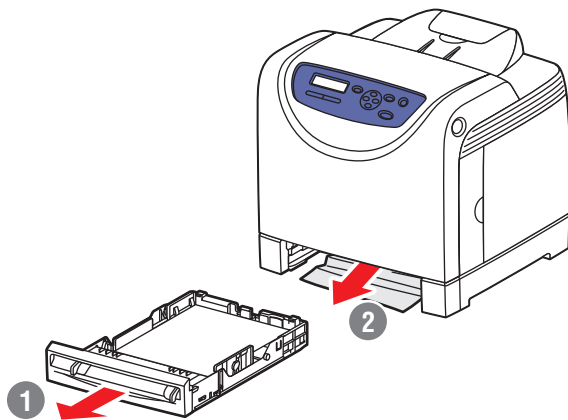
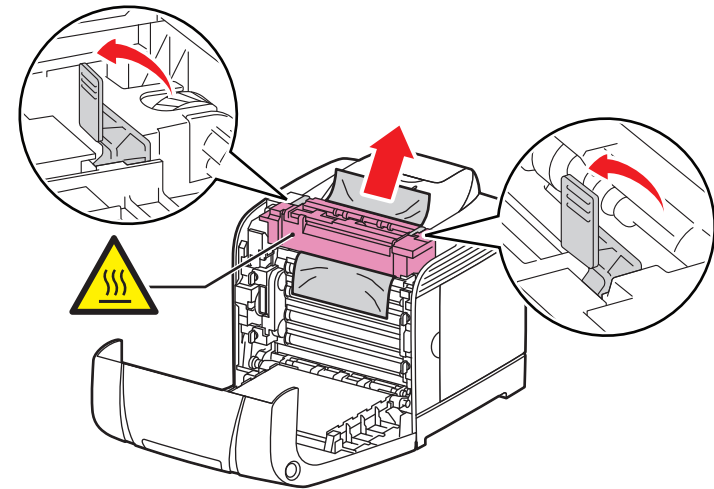

Also see [Print Quality](#) and [Troubleshooting](#) chapters in the *User Guide* for more information on:

- **Print-quality problems**
- **Color registration**
- **Error messages**