

IMPORTANT!!

This procedure is available for downloading at www.xerox.com:

- Click the **Support and Drivers** link.
- In **Product Name**, type the desired product name (6060, 7000, or 8000), and click **Search**.
- From the list presented, locate the correct product, and click the Download, or **Documentation** link.
- From the User Documentation list, select DocuColor 6060/7000/8000 Charge Corotron Cleaning Procedure.

Cleaning the Charge Corotrons

The DocuColor 6060 now uses a new Charge Corotron Assembly. For DocuColor 7000/8000 customers, the assembly is the same, but the part number is new:

- **The new Charge Corotron Assembly part number for DocuColor 6060/7000/8000 is 13R629.**

Each corotron assembly is equipped with a cleaning pad and a cleaning wand which makes it very easy to clean the corotron. The cleaning pad and wand are components of the Corotron Assembly; they are not separate parts.

Cleaning Pad

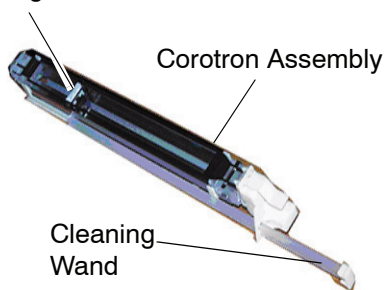

Tip: Each corotron unit should be cleaned one time daily in order to provide optimum image quality on your prints. It is recommended that you perform this procedure at the start of every day and after every 5,000 prints.

Use the following procedure for daily cleaning of the charge corotrons.

1. Open the front doors of the digital press.
2. Clean each corotron by **slowly** pulling out and

pushing in the Cleaning Wand one time.

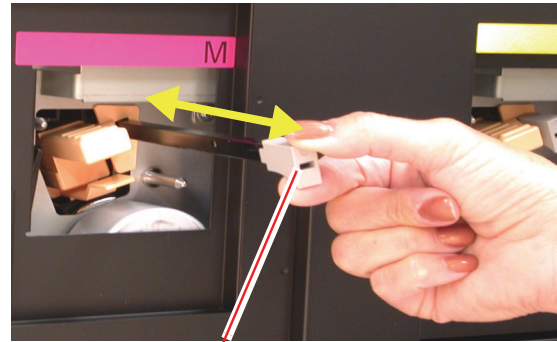

Slowly pull out the wand, then push it back in

Tip: To ensure proper cleaning of the pad, **slowly** pull out the wand **until it reaches the end of the assembly; it will stop when it reaches the end.** Slowly push in the wand until it is fully seated against the corotron assembly.

CAUTION: To avoid damage to the corotron assembly, **carefully** and **slowly** pull out the Cleaning Wand. Once the wand reaches the end of the assembly, it stops. Do not continue to pull on the wand as this will remove the wand from the Corotron Assembly, thereby damaging the assembly. If this occurs, you must replace the entire Corotron Assembly.

3. Ensure that the Cleaning Wand is pushed in completely.



- Verify that both the corotron assembly and the cleaning wand are seated properly. If either one is not seated properly, the User Interface displays a screen with the message: **“Reseat the Charge Corotron Unit.”**
- Select **Close** on the UI.
- Repeat Steps 2 and 3.

CAUTION: If any problems occur while cleaning the pad or reseating the wand, and/or if the above screen is continually displayed, call your Xerox service representative for assistance.

4. Once the Corotron Cleaning Wand is properly seated in the corotron assembly, the User Interface displays the message: **“Interlock Open. Close the right and left front doors.”**
5. Follow the instructions on the User Interface regarding the **Charge Corotron End-of-Life** counter.
6. Repeat Steps 1-5 until all the corotrons are cleaned.